

Mile Point	Dist to Turn	Dir	Street	Land Mark
	0.2		CHECK POINT #1 K-Mart Parking Lot	Grandview
0.2	0.2	R	139th	
0.3	0.1	R	15th	
0.8	0.5	L	135th	
1.5	0.7	R	5th	
2.1	0.6	L	Main (also 129th)	
4.2	2.1	L	Blue Ridge	
			State Line	
6.1	1.9	L	becomes Kenneth becomes 159th	
10.7	4.6	L	Mission	
15.9	5.2	R	199th	
26.7	10.8	L	Webster	
26.8	0.1	L	Webster	Springhill
29.9	3.1	R	West 223rd	
30.1	0.2	L	Old KC Road	
37.6	7.5	L	279th	
37.7	0.1	R	Hedge Ln	
41.3	3.6	R	Baptiste	
41.4	0.1	L	CHECK POINT# 2 Phillips 66	Paola

Mile Point	Dist to Turn	Dir	Street	Land Mark
		R	Leave Check point #2 Right onto Baptiste	
42.0	0.6	R	Hedge Ln	
43.4	1.4	ST	Hedge Ln (also 319th)	
45.8	2.4	R	Block	
48.9	3.1	R	343rd	
52.0	3.1	L	Hedge Ln	
63.5	11.5	L	East 152 Hwy	LaCygne
72.3	8.8		152 Hwy Bears Right	
79.0	6.7	ST	J Hwy	Amsterdam
83.0	4.0	L	F Hwy	
93.2	10.2	R	Bus 71 South	
97.9	4.7	R	Ft Scott Street	
98.6	0.7	L	CHECK POINT# 3 Conoco	Butler

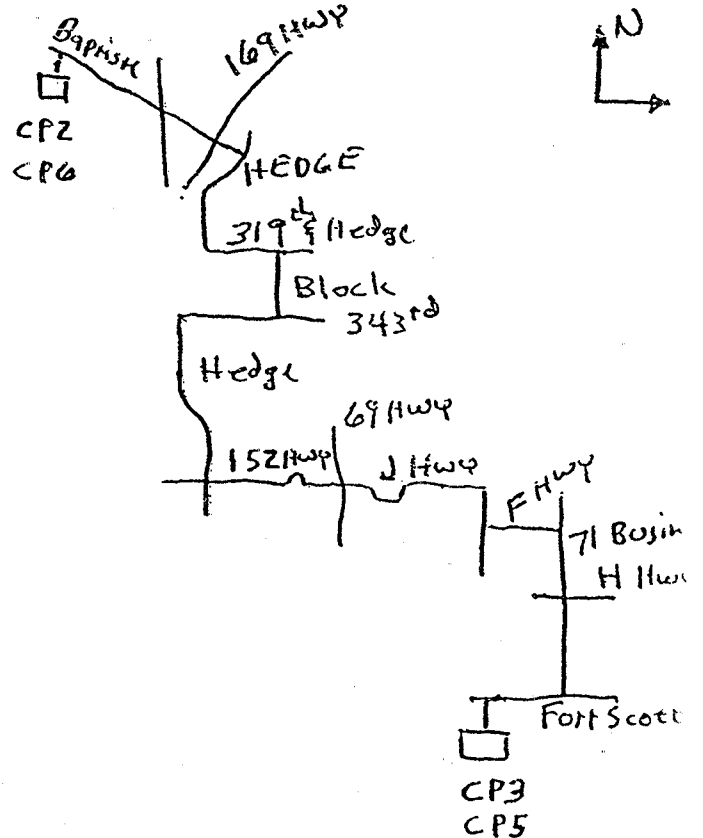
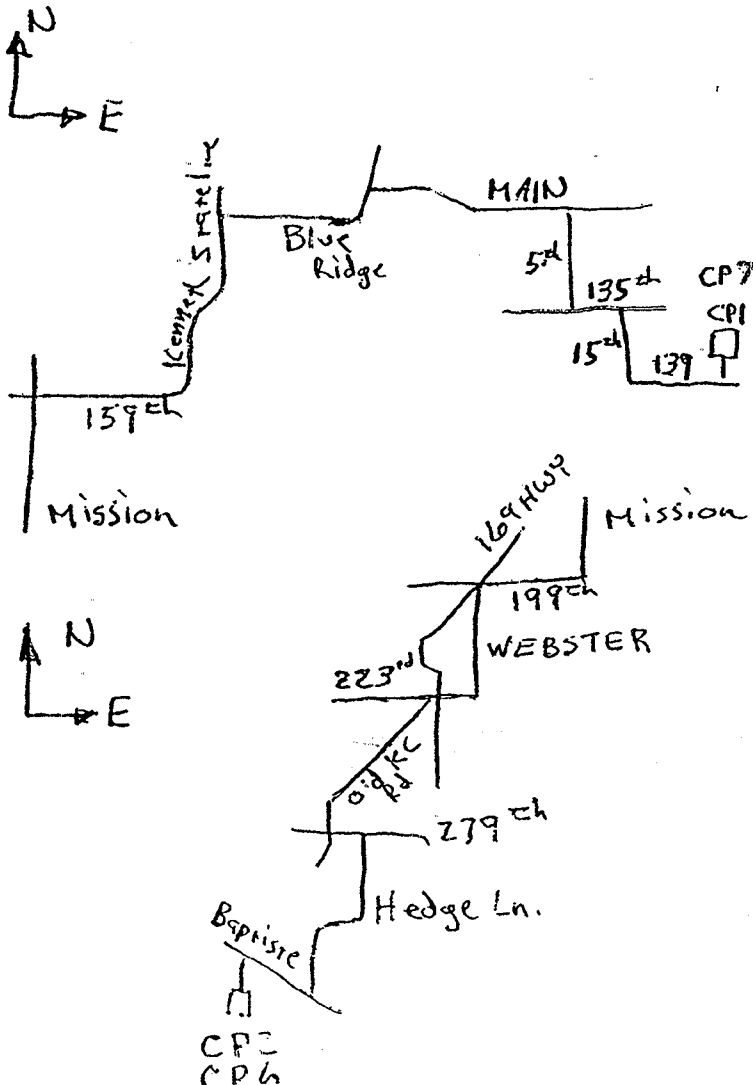

3

400KB

4

Mile Point	Dist to Turn	Dir	Street	Land Mark
		R	Leave Checkpoint #3 Right onto Ft Scott Street	
99.3	0.7	L	71 Business	
99.8	0.5	R	H Hwy	
117.8	18.0	R	KK Hwy	
123.0	5.2	L	52 Hwy	
123.7	0.7	L	CHECK POINT #4 AMCO'S <i>CRIST'S</i>	Appleton City

Mile Point	Dist to Turn	Dir	Street	Land Mark
		R	Leave Check Point#4 Right onto 52Hwy	
124.4	0.7	R	KK Hwy	
129.6	5.2	L	H Hwy	
147.6	18.0	L	71 Business	
148.1	0.5	R	Ft Scott Street	
148.8	0.7	L	CHECK POINT #5 Conoco	Butler

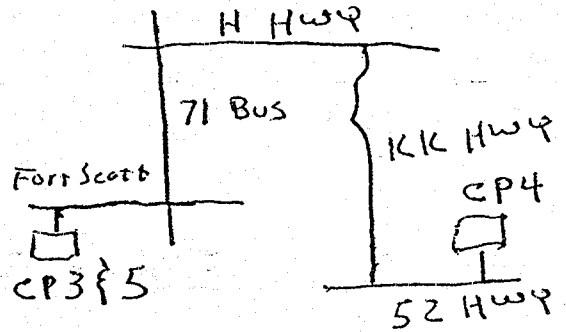
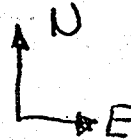
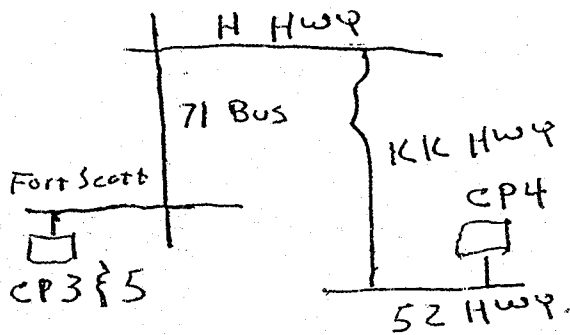

#3A

600KBrevet

pg 4 of 8

Mile Point	Dist to Turn	Dir	Street	Land Mark
123.7	0.0	L	Depart Checkpoint#4 Left onto 52	
125.0	1.3	R	A Hwy	
127.1	2.1	R	Veer Right on A Hwy / H Hwy	
141.4	14.3	L	O Hwy	
145.3	3.9	L	82 Hwy	
146.0	0.7	R	DD Hwy	
153.3	7.3	ST	Cross 54 Hwy onto 39 54 HWY	
161.6	8.3	ST	N Hwy	
177.3	15.7	ST	Cross 13 Hwy Becomes V	Humansville
177.5	0.2	L	123 Hwy	
177.9	0.4	L	123 Hwy bears Left	
185.1	7.2	R	54 Hwy	Weaubleau
185.4	0.3	L	CHECKPOINT#5 DOUBLE D PIT STOP	

#3B

600KBrevet

pg 5 of 8

Mile Point	Dist to Turn	Dir	Street	Land Mark
185.4	0.0	R	Depart Checkpoint#5 Right onto 54	
185.7	0.3	L	123 Hwy	
192.9	7.2	R	123 veers right	
193.3	0.4	R	V Hwy	Humansville
193.5	0.2	ST	Cross 13 Hwy onto N	Humansville
209.2	15.7	ST	39 Hwy (N HWY)	
217.5	8.3	ST	Cross 54 HWY onto DD Hwy	Cedar Springs
224.8	7.3	L	82 Hwy	
225.5	0.7	R	O Hwy	
229.4	3.9	R	H Hwy	
243.7	14.3	ST	A Hwy	
245.8	2.1	L	52 Hwy	
247.1	1.3	R	CHECKPOINT#6 CASPY'S	Appleton City

Mile Point	Dist to Turn	Dir	Street	Land Mark
		R	Leave Check Point#5 Right onto Ft Scott	
149.5	0.7	L	71 Business	
154.2	4.7	L	F Hwy	
164.4	10.2	R	J Hwy	
168.4	4.0		J Hwy Bears Left	
175.1	6.7	L	152 Hwy	
183.9	8.8	R	Hedge Ln	
195.4	11.5	R	343rd St	
198.5	3.1	L	Block	
201.6	3.1	L	Hedge Lane (319th)	
204.0	2.4	STR (R)	Hedge Ln	
205.4	1.4	L	Baptiste	
206.0	0.6	L	CHECK POINT #6 Phillips 66	Paola

Mile Point	Dist to Turn	Dir	Street	Land Mark
		R	Leave Check Point #6 Right onto Baptiste	
206.1	0.1	L	Hedge Ln	
209.7	3.6	L	279th	
209.8	0.1	R	Old KC Road	
217.3	7.5	R	223rd	
217.5	0.2	L	Webster	
220.6	3.1	R	Webster	Springhill
220.7	0.1	R	199th	
231.5	10.8	L	Mission 159th	
236.7	5.2	R	becomes Kenneth becomes State Line	
241.3	4.6	R	Blue Ridge	
243.2	1.9	R	Main (also 129th)	Grandview
245.3	2.1	R	5th	
245.9	0.6	L	135th	
246.6	0.7	R	15th	
247.1	0.5	L	139th	
247.3	0.2	L	CHECK POINT #7 K-Mart Parking Lot	Grandview

